

**PAPER TRAY UNIT**  
**(Machine Code: G555)**

**ENVELOPE FEEDER**  
**(Machine Code: G556)**

# 1. REPLACEMENT AND ADJUSTMENT

## ⚠ CAUTION

Turn off the main power switch and unplug the machine before attempting any of the procedures in this section.

**NOTE:** This manual uses several symbols. The meanings of those symbols are as follows:

☛: See or Refer to

🔩: screw

🔌: connector

## 1.1 PAPER FEED UNIT

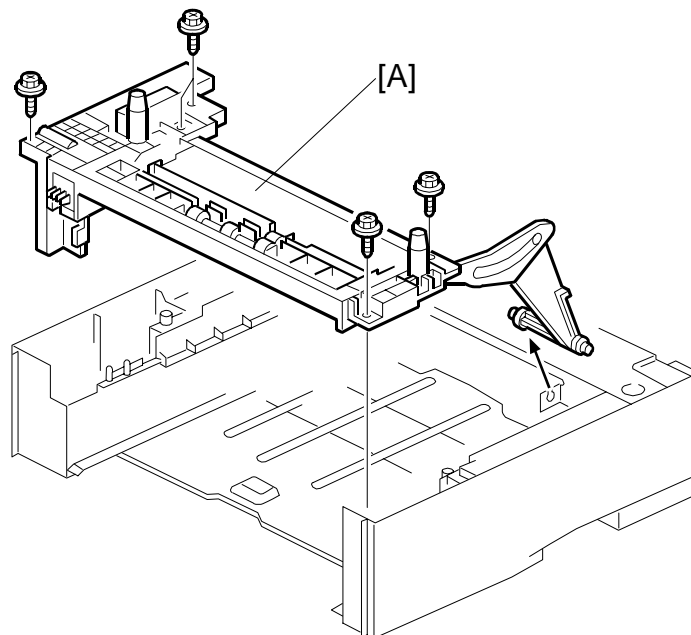

G555R101.WMF

- Remove the paper tray unit from the main unit.
- Draw out the paper tray.

[A]: Remove the paper feed unit ( 📌 x5).

## 1.2 PAPER FEED ROLLER

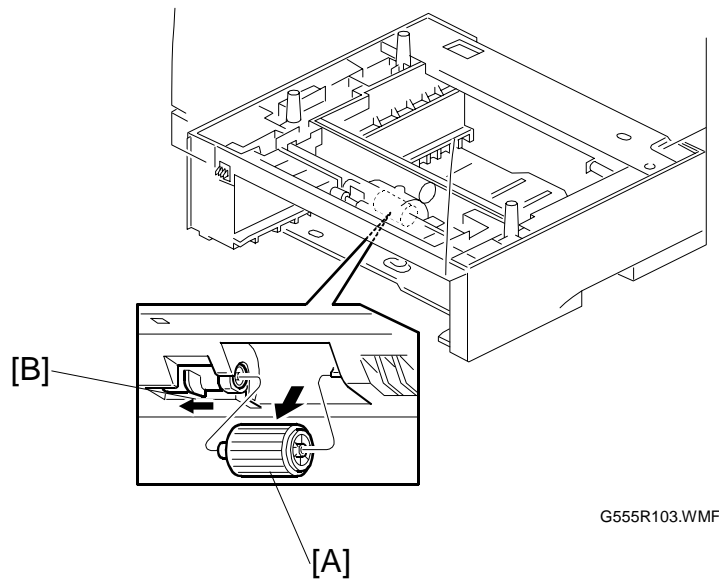

- Draw out the paper tray

[A]: Paper feed roller (move the lever [B] to the left)

## 1.3 FRICTION PAD

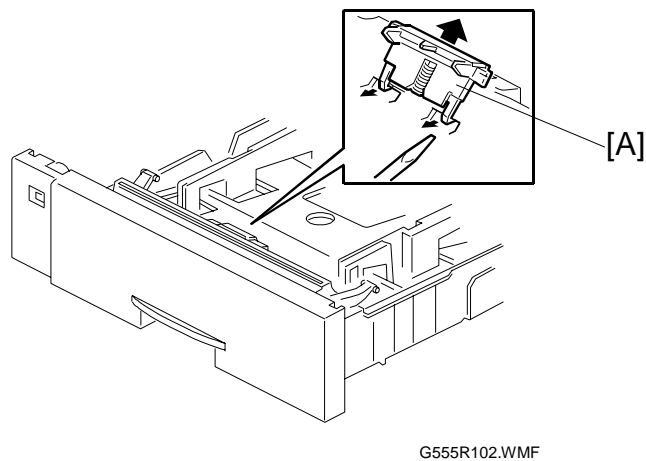

- Draw out the paper tray.

[A]: Friction pad

## 2. DETAILED DESCRIPTIONS

### 2.1 OVERALL MACHINE INFORMATION

#### 2.1.1 MECHANICAL COMPONENT LAYOUT

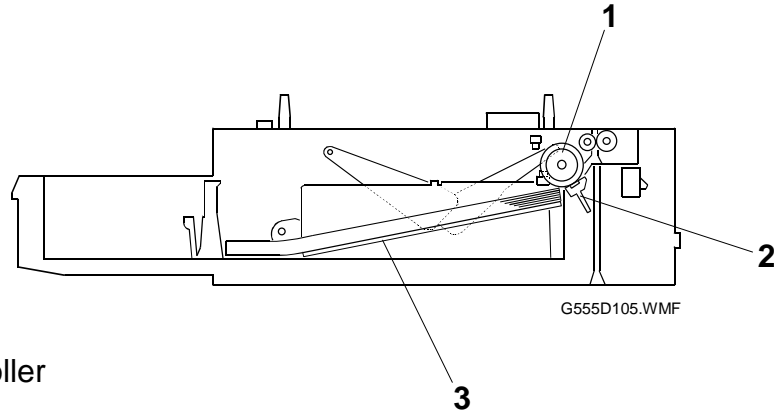

- 1. Paper feed roller
- 2. Friction pad
- 3. Bottom plate

#### 2.1.2 ELECTRICAL COMPONENT LAYOUT

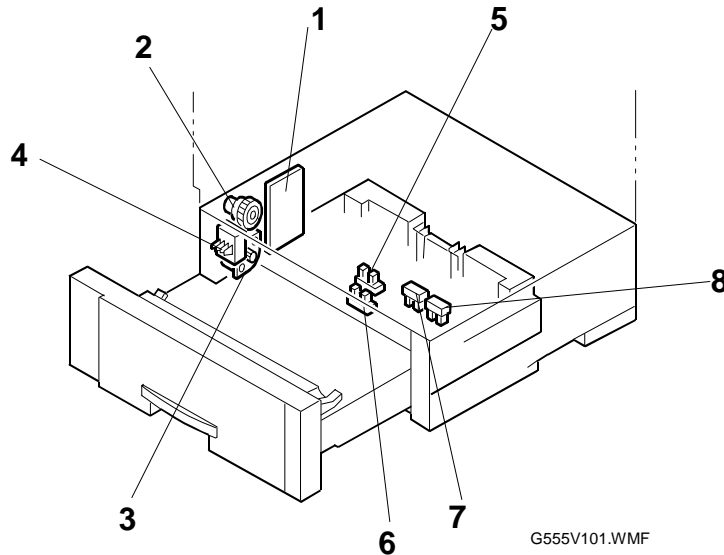

- 1. Paper tray board
- 2. Paper feed clutch
- 3. Paper feed motor
- 4. Paper size switch
- 5. Paper end sensor
- 6. Paper feed sensor
- 7. Paper height sensor
- 8. Paper height sensor

Peripherals

## 2.2 DETAILED SECTION DESCRIPTIONS

### 2.2.1 PAPER FEED AND SEPARATION

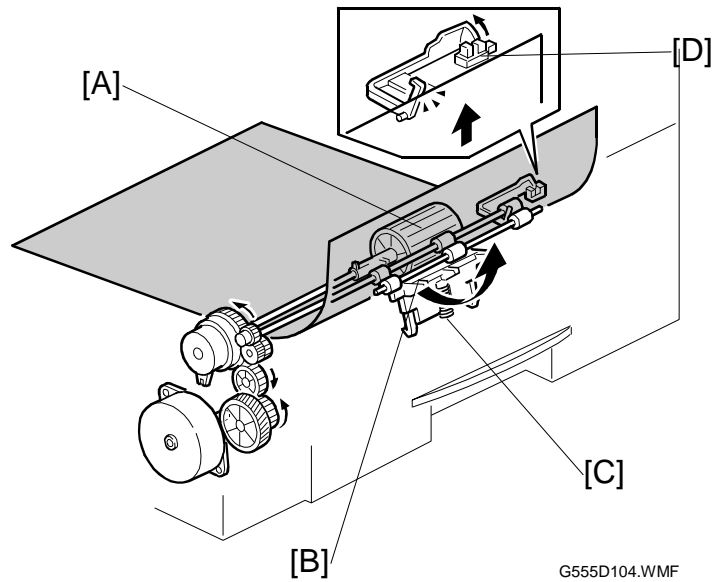

- The paper tray holds 500 sheets.
- The paper feed unit uses a feed roller and friction pad mechanism.
  - [A]: Paper feed roller
  - [B]: Friction pad
  - [C]: Pressure spring
  - [D]: Paper feed sensor

## 2.2.2 PAPER LIFT

Paper lift is the same as for the main unit.

## 2.2.3 PAPER END DETECTION

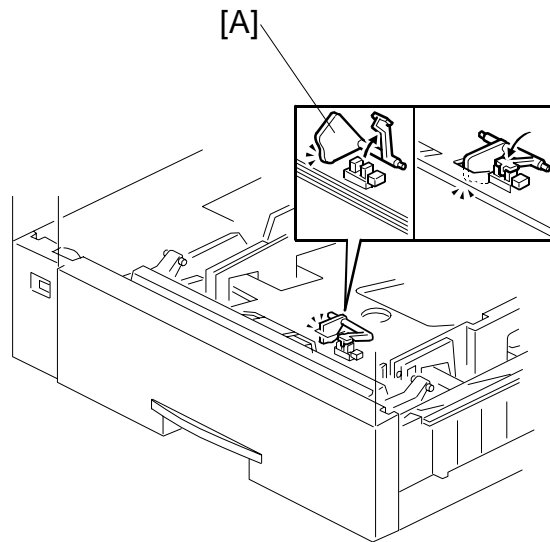

G555D103.WMF

- When the paper tray runs out of paper, the feeler [A] drops into the cutout in the bottom plate to actuate the paper end sensor.

### 2.2.4 PAPER HEIGHT DETECTION

- The paper height is detected by the combination of the paper height sensor signals. The signals from the sensors indicate whether there are 450, 250, or 50 sheets remaining.

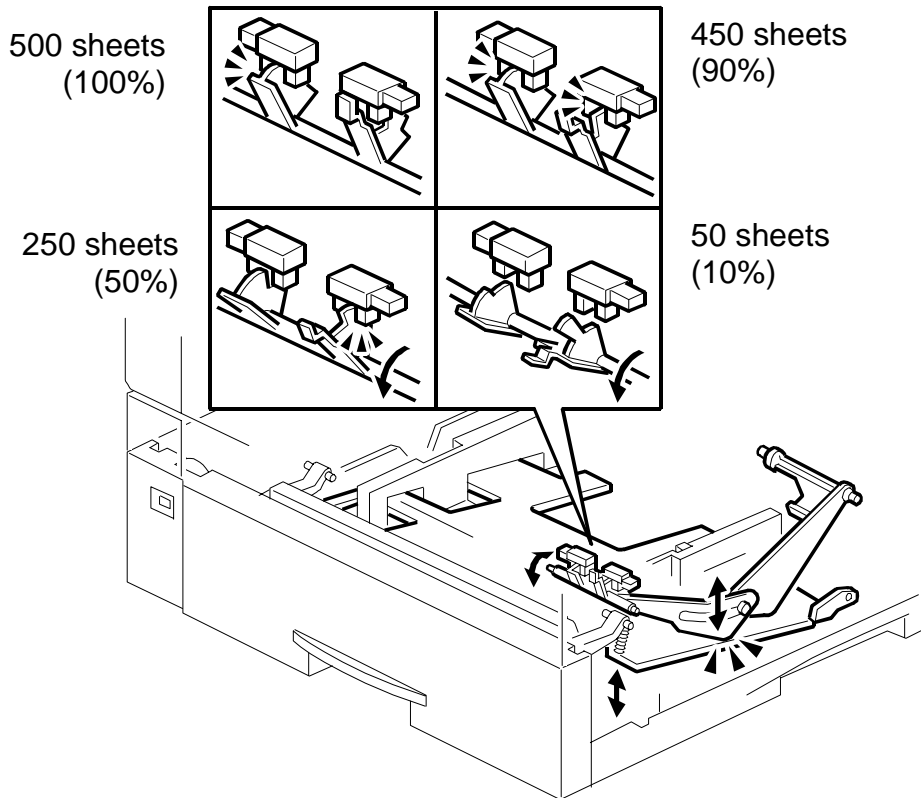

G555D106.WMF

| Amount of paper | Paper height sensor 1 | Paper height sensor 2 |
|-----------------|-----------------------|-----------------------|
| 50 sheets       | OFF                   | OFF                   |
| 250 sheets      | OFF                   | ON                    |
| 450 sheets      | ON                    | ON                    |
| 500 sheets      | ON                    | OFF                   |

OFF: Unblocked, ON: Blocked

### 2.2.5 PAPER SIZE DETECTION

| Size                     | SW | 1 | 2 | 3 | 4 |
|--------------------------|----|---|---|---|---|
| A3                       |    | ● | ● | ● | ● |
| A4 LEF (Long Edge Feed)  |    | ● | ● | ○ | ○ |
| A4 SEF (Short Edge Feed) |    | ● | ● | ● | ○ |
| 8 1/2" x 11" LEF         |    | ● | ○ | ○ | ● |
| 11" x 17"                |    | ● | ○ | ● | ● |
| 14" x 8 1/2" SEF         |    | ● | ○ | ● | ○ |
| 11" x 8 1/2" SEF         |    | ● | ● | ○ | ● |
| * (Asterisk)             |    | ● | ○ | ○ | ○ |

○: ON (Not pushed)  
 ●: OFF (Pushed)

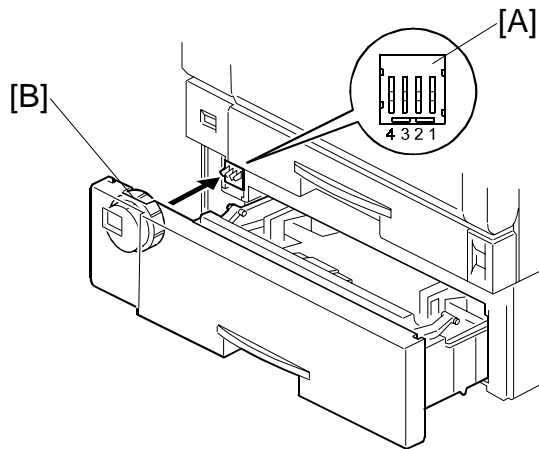

G555D102.WMF

[A]: Paper size switch  
 [B]: Paper size dial

- The machine disables paper feed from a tray if the paper size cannot be detected (if the paper size actuator is broken or no tray is installed)
- When the paper size dial is at the "\*" mark, the paper tray can be set up to accommodate one of a wider range of paper sizes by using a User Tool at the machine's operation panel (Paper Input menu – Tray Paper Size).



## **3. ENVELOPE FEEDER**

### **3.1 OVERALL MACHINE INFORMATION**

#### **3.1.1 MECHANICAL COMPONENT LAYOUT**

- This optional unit is a tray that slides into the optional paper feed unit, replacing the paper tray.
- If two optional trays have been installed, the envelope feeder must go into the top tray.
- The layout is the same as the paper tray.
- The friction pad in this unit is rubber-coated. The friction pad in the paper tray unit is made of cork.